

**LEGEND**

—	PROPERTY LINE	—	EXISTING WALL
- - -	EXISTING EDGE OF PAVEMENT	- - -	EXISTING SEWER
- - -	BUILDING ENVELOPE	- - -	EXISTING WATER LINE
⊖	EXISTING STONE WALL	- - -	EXISTING GAS LINE
⊖	EXISTING CONTOUR	⊖	PARKING SPACES NUMBER
⊖	PROPOSED CONTOUR	⊖	HANDICAP PARKING SPACE
⊖	EDGE OF WETLANDS	⊖	EOP
⊖	WETLAND FLAG	⊖	EDGE OF PAVEMENT
⊖	100' WETLANDS BUFFER ZONE	⊖	EROSION CONTROL BARRIER
⊖	EXISTING BUILDING	⊖	PROPOSED BUILDING
⊖	EXISTING TREE	⊖	PROPOSED DRAIN LINE
⊖	EXISTING SPOT GRADE	⊖	PROPOSED CABLE/TELEPHONE/ELECTRIC
⊖	580x50 PROPOSED SPOT GRADE	⊖	PROPOSED SEWER MAIN
⊖	EXISTING TREE LINE	⊖	PROPOSED WATER LINE
⊖	EXISTING UTILITY POLE	⊖	PROPOSED PAVEMENT
⊖		⊖	PROPOSED TREE

**ASHBY PLANNING BOARD**

DATE OF ENDORSEMENT & APPROVAL: \_\_\_\_\_

CHAIRMAN: \_\_\_\_\_

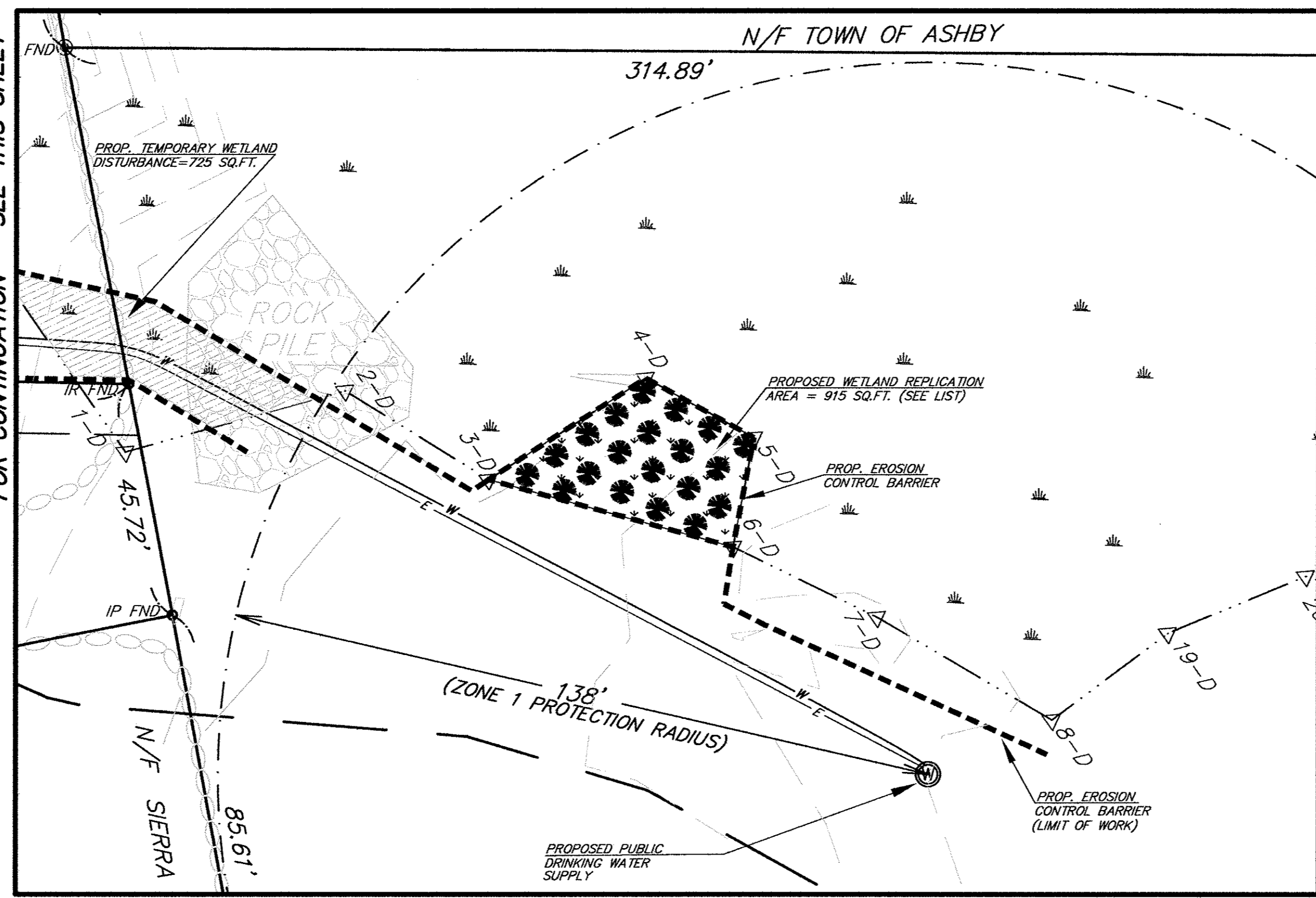

**PLANTING LIST**  
WETLANDS REPLICATION AREA

RECOMMENDED PLANTINGS:

PLANT SPECIES	COMMON NAME	SPACING	NUMBER
VIBURNUM RECOGNITUM	NORTHERN ARROWWOOD	7' ON CENTER	5
VIBURNUM CASSINOIDES	WITHEROOD	7' ON CENTER	5
ILEX VERTICILLATA	WINTERBERRY	7' ON CENTER	5
CORNUS AMOMUM	SILKY DOGWOOD	7' ON CENTER	5
WETLANDS SEED MIX	NEW ENGLAND "WETMIX" (FROM NEW ENGLAND WETLAND PLANTS, AMHERST, MA OR EQUIVALENT)	GENERAL GROUND COVER, BROADCAST SEEDING	

NOTES:  
PLANTING LAYOUT/SEQUENCE SHALL CONFORM TO THE LAYOUT INDICATED ON THIS DETAIL SHEET.  
THE SPECIES SELECTED SHALL BE PLANTED OVER THE ENTIRE AREA IN AN EVEN DISTRIBUTION.

FOR CONTINUATION - SEE THIS SHEET

**Daniel S. Wolfe**  
REGISTERED PROFESSIONAL ENGINEER  
1-3-11  
REVISIONS

**873 MAIN STREET**  
**GRADING & UTILITY PLAN**

SITE PLAN IN  
**Ashby, Mass.**  
PREPARED FOR  
**DLR REALTY TRUST**

SCALE: 1" = 20'      DECEMBER, 2010

**David E. Ross Associates, Inc.**  
CIVIL ENGINEERS - LAND SURVEYORS  
ENVIRONMENTAL CONSULTANTS  
PO BOX 368-111 FITCHBURG RD, AYER, MA 01432  
(TEL. NO. 978-772-6232)

JOB NO. 24062    SHEET 3 OF 11    PLAN NO. L-11529

FOR CONTINUATION - SEE THIS SHEET